

MEMORY STOP

1. MEMORY STOP ADAPTOR PLATE

-THE ADAPTOR PLATE IS FASTENED TO THE QUADRANT WITH 2 M5 THREADFORMING SCREWS

2. SPLINED MEMORY STOP HUB

-THE HUB IS FASTENED WITH TWO ROLL PINS TO ADAPTOR PLATE.

3. MEMORY STOP ADJUSTMENT RING

-FIRST, A DOWEL PIN IS PRESS FITTED INTO A DRILL HOLE IN THE SIDE OF THE ADJUSTMENT RING. THEN, THE RING IS FITTED AROUND THE SPLINED HUB.

5. INDICATOR CAP

-AN INDICATOR CAP IS MOUNTED WITH CAP SCREWS THROUGH THE SPLINED HUB TO THE ADAPTOR PLATE, THE INDICATOR CAP HAS AN ADDED FUNCTION OF HOLDING THE ADJUSTMENT RING IN POSITION.

4. MEMORY STOP SPACER

-A HOLLOW CYLINDRICAL SPACER IS FASTENED TO THE COVER WITH A CAP SCREW.

STOP SPACER LOCATION FOR MX, MV, & MY

6. FULLY ASSEMBLED ACTUATOR WITH A MEMORY STOP ACCESSORY ATTACHED

-AFTER REMOVING THE INDICATOR CAP, THE ADJUSTMENT RING CAN BE SET IN ANY POSITION DESIRED AROUND THE HUB, WHICH, IN TURN, MAKES IT POSSIBLE TO CONTROL THE AMOUNT OF VALVE ACTUATION PRODUCED BY THE GEARBOX.

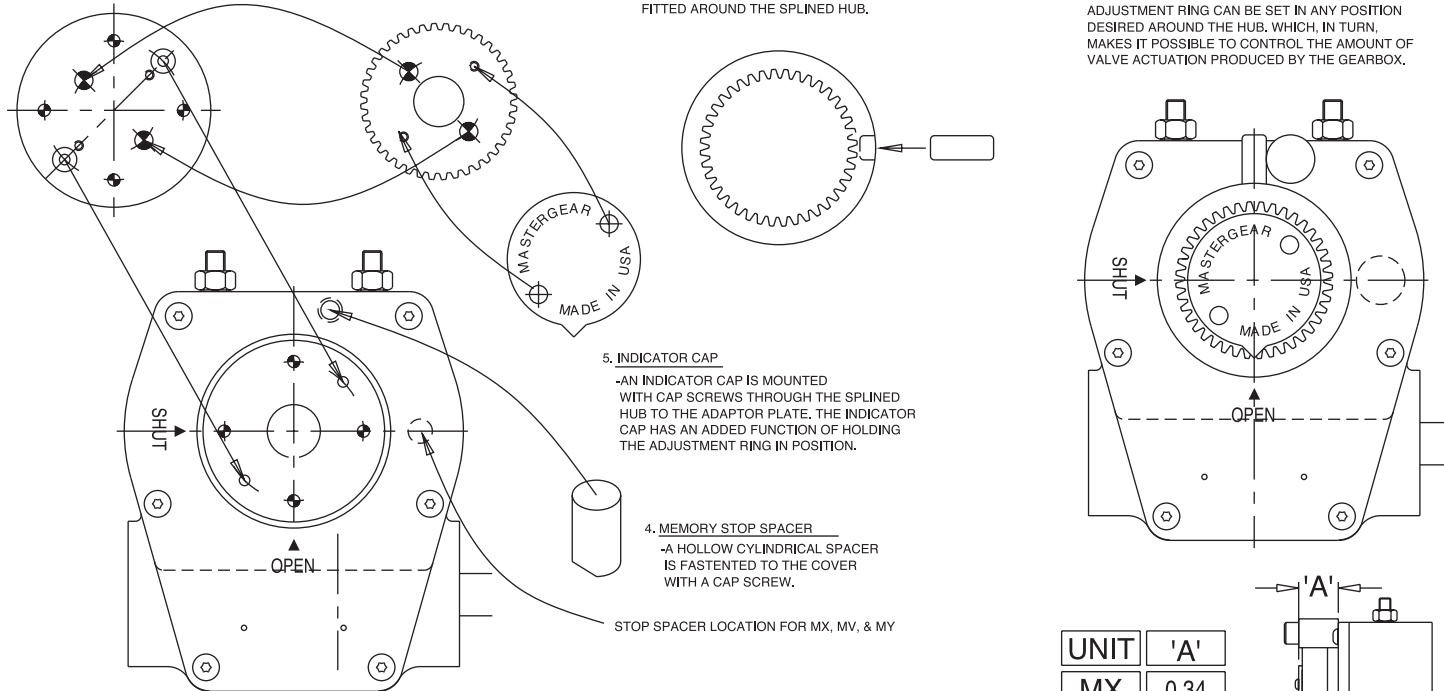

MASTERGEAR

DIVISION OF REGAL-BELOIT CORPORATION
5466 EAST ROCKTON RD. SOUTH BELOIT, IL 61080

THIS DRAWING/DESIGN IS THE PROPERTY OF MASTERGEAR, AND MUST NOT BE USED WITHOUT THEIR SPECIFIC WRITTEN CONSENT. ©

DO NOT SCALE
APPROVED BY
JRH

DRAWING No.
MU 6000
REV. A
6/3/98

UNIT	'A'
MX	0.34
MV	0.75
MY	0.75
MA	1.375
MB	1.375

