

# A33 BEVEL GEAR ISO

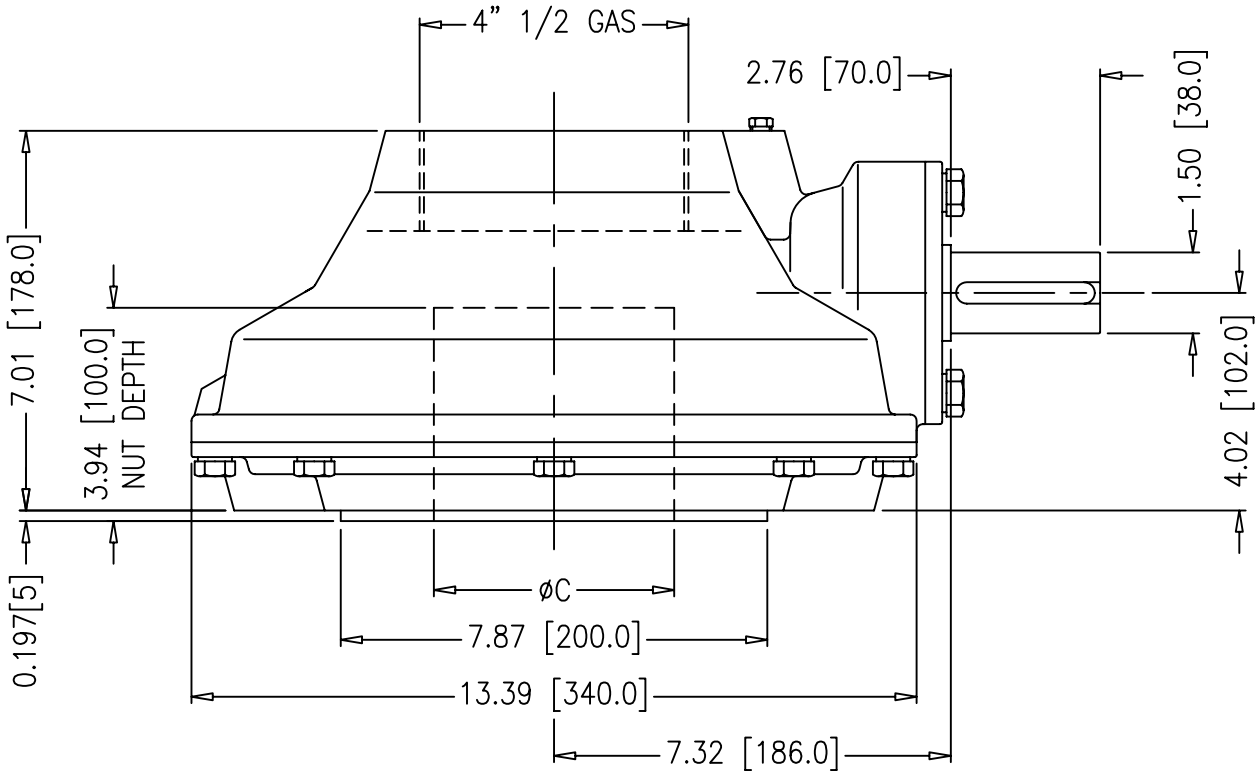

M16 TAP~ 8 HOLES  
ON A 10.00[254mm] B.C.D.

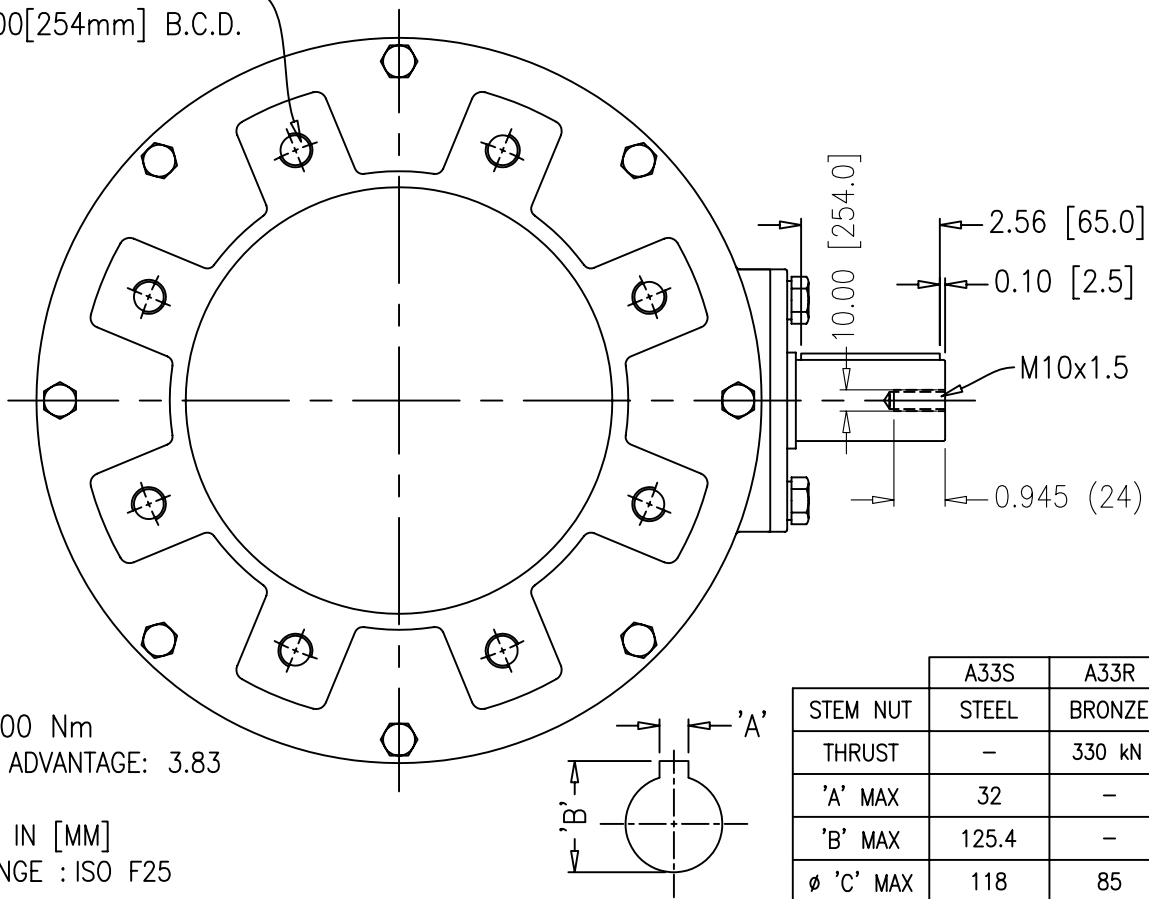

**NOTES:**

1. TORQUE: 2300 Nm
2. MECHANICAL ADVANTAGE: 3.83
3. RATIO: 4.5:1
4. DIMENSIONS: IN [MM]
5. OUTPUT FLANGE : ISO F25

	A33S	A33R
STEM NUT	STEEL	BRONZE
THRUST	-	330 kN
'A' MAX	32	-
'B' MAX	125.4	-
$\phi$ 'C' MAX	118	85



**COSTRUZIONI MECCANICHE LEGNANESI**

**MASTERGEAR**

DIVISION OF REGAL-BELOIT CORPORATION  
5466 EAST ROCKTON RD. SOUTH BELOIT, IL 61080

THIS DRAWING/DESIGN IS THE PROPERTY OF MASTERGEAR. AND MUST NOT BE USED WITHOUT THEIR SPECIFIC WRITTEN CONSENT. ©

DO NOT SCALE  
APPROVED BY  
LD

DRAWING No.  
**A33 ISO**  
REV.0  
16-04-03