

# NF SERIES NAMUR FLOW CONTROL

The MASTERGEAR NF Series NAMUR Flow Controls are designed to be wafer mounted between a NAMUR solenoid valve (1/4") and NAMUR actuators (1/4") eliminating costly tubing and fittings. These combination needle/check valves permit restriction of the air flow rate and thus allow the speed of the actuator to be controlled. The NF Series can be used by itself with a NP1/4 NAMUR adapter module.

## NF1

The MASTERGEAR NF1 NAMUR flow control is used for unidirectional speed control. It is used to adjust closing or opening speed only. Only one direction of rotation can be adjusted. It can be used both with double acting or spring return actuators.

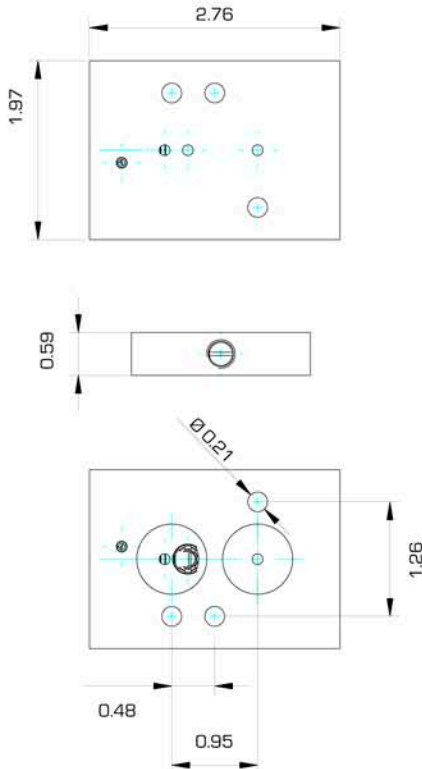

## NF2

The MASTERGEAR NF2 NAMUR flow control is a bi-directional speed control for double acting actuators. It is used to adjust closing and opening speeds.

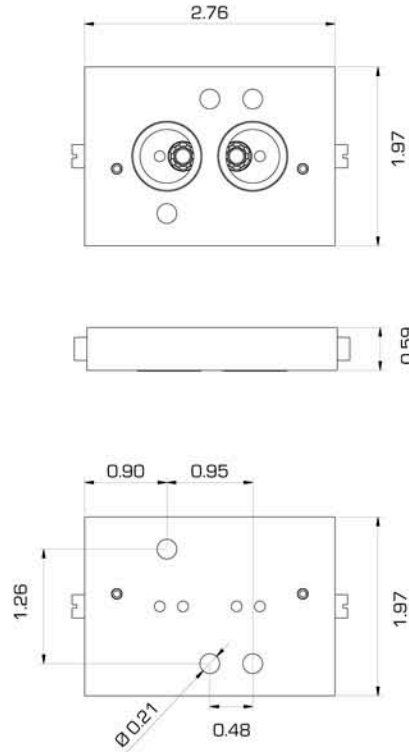

## NF3

The MASTERGEAR NF3 NAMUR flow control is a bi-directional speed control for spring return actuators. It is used to adjust closing and opening speed (also suitable for use with solenoid valve with air purge function).

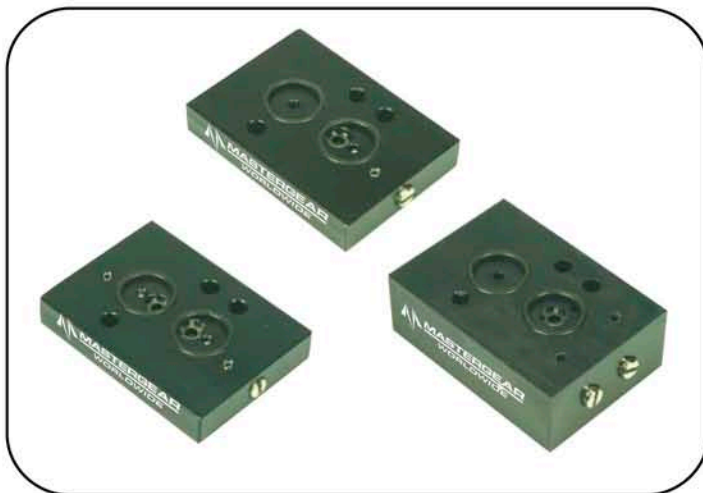
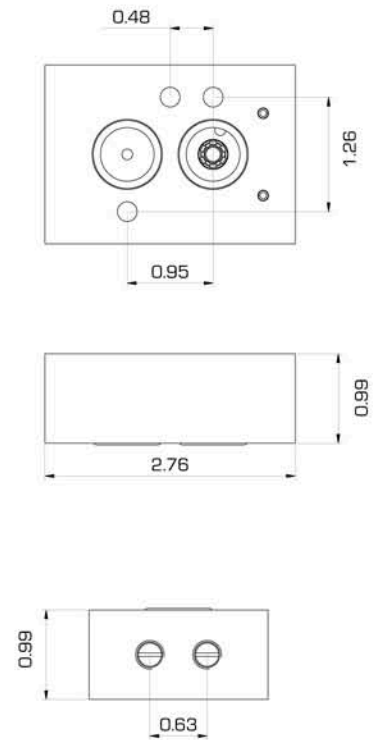

## TECHNICAL SPECIFICATION

Temperature range	: -4°F (-20°C) +176°F (+80°C)
Max pressure	: 116 psi (8 bar)
Media	: dry or lubricated non-corrosive gas compatible with nitrile seals
Nominal bore	: 0 - 0.12 inch (3 mm)

## MATERIALS

Body	: anodized aluminium
Screws	: stainless steel
Seals	: nbr



A REGAL-BELOIT COMPANY  
 5466 EAST ROCKTON RD. SOUTH BELOIT, IL 61080  
 Phone: 800-722-7643  
[www.mastergearworldwide.com](http://www.mastergearworldwide.com)