

TRAVEL 90° ±5° AT BOTH ENDS
 RATIO 1219.8:1
 TURNS TO CLOSE 304.95

MECHANICAL ADVANTAGE..... 384.6 ±10%
 MAXIMUM OUTPUT TORQUE (1000 CYCLES)..... 442300 lb.ins.
 MAXIMUM INPUT TORQUE (1000 CYCLES)..... 1150 lb.ins.

MOUNTING HOLE DETAIL (BSENISO 5211:2001)

APPROXIMATE WEIGHT 940 lb.

PREFERRED F48 (12 x M36 on 19.16" PCD)
 MAXIMUM F48 (12 x M36 on 19.16" PCD)
 MINIMUM F25 (8 x M16 on 10.00" PCD)



OPPERMAN MASTERGEAR

Hambridge Lane, Newbury, Berkshire, RG14 5TS. ENGLAND
 Tel: 01635 811500 Fax: 01635 811501 E-Mail: sales@opperman-mastergear.co.uk

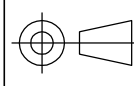

To BS308

DIMENSIONS IN
 MM [INCHES]

DATE	11Aug09
DRAWN	PAB
CHECKED	
SCALE	1:8